

REAR MOUNTING STRAIGHT BULKHEAD

R214.312.000

CRIMP TYPE - CABLE 2.6/75 S

Series : **SMZ**

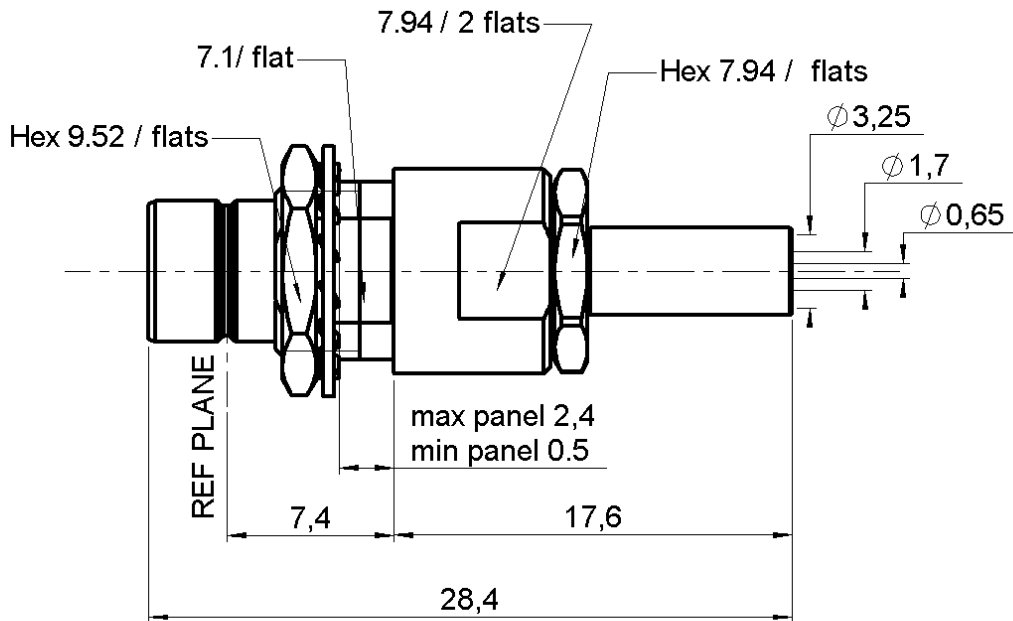

PANEL CUT OUT

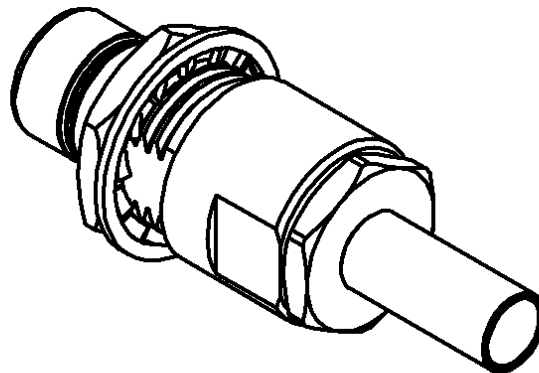
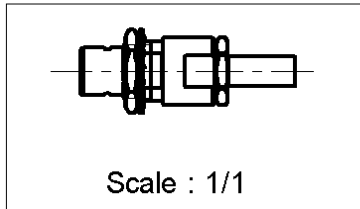
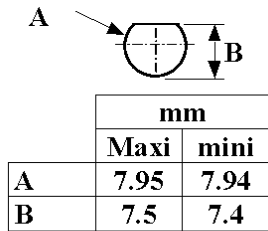

All dimensions are in mm.



COMPONENTS	MATERIALS	PLATINGS (µm)
BODY	BRASS	GOLD 0.2 OVER NICKEL 2
CENTER CONTACT	BRASS	GOLD 1.3 OVER NICKEL 2.54 OVER COPPER
OUTER CONTACT	-	3
INSULATOR	PTFE	-
GASKET	-	-
OTHERS PARTS	BRASS	GOLD 0.2 OVER NICKEL 2
-	-	-
-	-	-

Issue : 9908 B

In the effort to improve our products, we reserve the right to make changes judged to be necessary.



REAR MOUNTING STRAIGHT BULKHEAD

R214.312.000

CRIMP TYPE - CABLE 2.6/75 S

Series : **SMZ**

PACKAGING

Standard	Unit	Other
100	'W' option	Contact us

SPECIFICATION

CABLE ASSEMBLY

ELECTRICAL CHARACTERISTICS

Stripping	a	b	c	d	e	f
mm	2.25	6.90	16.2	0.00	14.0	0.00

Impedance		75	Ω
Frequency		0-2.4	GHz
VSWR	1.20 +	0.000	x F(GHz) Maxi
Insertion loss		0.12	\sqrt{F} (GHz) dB Maxi
RF leakage	- (60	- F(GHz)) dB mini
Voltage rating		250	Veff Maxi
Dielectric withstanding voltage		750	Veff mini
Insulation resistance		500	M Ω mini

Assembly instruction : **Crimp 10**

Recommended cable(s)
RG 187
RG 179

Cable retention
- pull off **120** N mini
- torque **NA** N.cm

MECHANICAL CHARACTERISTICS

TOOLING

Center contact retention			
Axial force – Mating end	10	N	mini
Axial force – Opposite end	10	N	mini
Torque	NA	N.cm	mini

Part Number	Description	Hexagon
.	.	.
R282.211.000	CRIMPING TOOL	3.25
R282.235.003	CRIMPING DIES	3.25
R282.293.000	CRIMPING TOOL	-

Recommended torque			
Mating	NA	N.cm	
Panel nut	170	N.cm	
Clamp nut	100	N.cm	
A/F clamp nut	7.940	mm	

OTHERS CHARACTERISTICS

Mating life	250	Cycles	mini
Weight	0.000	g	

ENVIRONMENTAL

Operating temperature	-55/+155	$^{\circ}$ C
Hermetic seal	NA	Atm.cm3/s
Panel leakage	NA	

Issue : **9908 B**

In the effort to improve our products, we reserve the right to make changes judged to be necessary.

